

**CONFIGURATION**

**/S** Modifier 65-45-12 Ductile Iron, Buna-N, Blackened

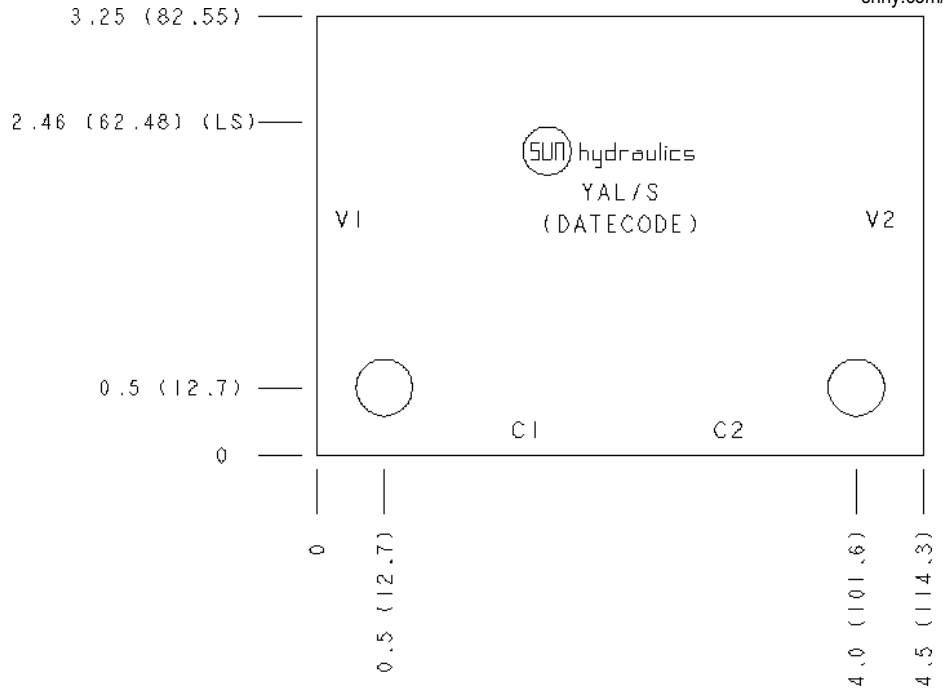

**TECHNICAL DATA**

Body Type	Line mount
Interface	None
Body Features	Cross pilot
Mounting Hole Diameter	.42 in.
Mounting Hole Depth	Through
Mounting Hole Quantity	2
Open Cavities	2
Cavity	T-2A
Port Size	SAE 12
Model Weight	3.81 lb.

**NOTES**

**Important:** Carefully consider the maximum system pressure. The pressure rating of the manifold is dependent on the manifold material, with the port type/size a secondary consideration. Manifolds constructed of aluminum are not rated for pressures higher than 3000 psi (210 bar), regardless of the port type/size specified.

**PORT DESIGNATORS**

Modifiers	Ports
YAL	All Ports: SAE 12;

**CONFIGURATION OPTIONS**  
Model Code Example: YAL/S

**MODIFIER** \_\_\_\_\_ (**/S**)  
**/S** 65-45-12 Ductile Iron, Buna-N, Blackened  
 6061-T651 Aluminum, Buna-N

**MANIFOLD FACES**

**FACE GRID**



5	6	7	8
9	10	11	12

**Face 2**

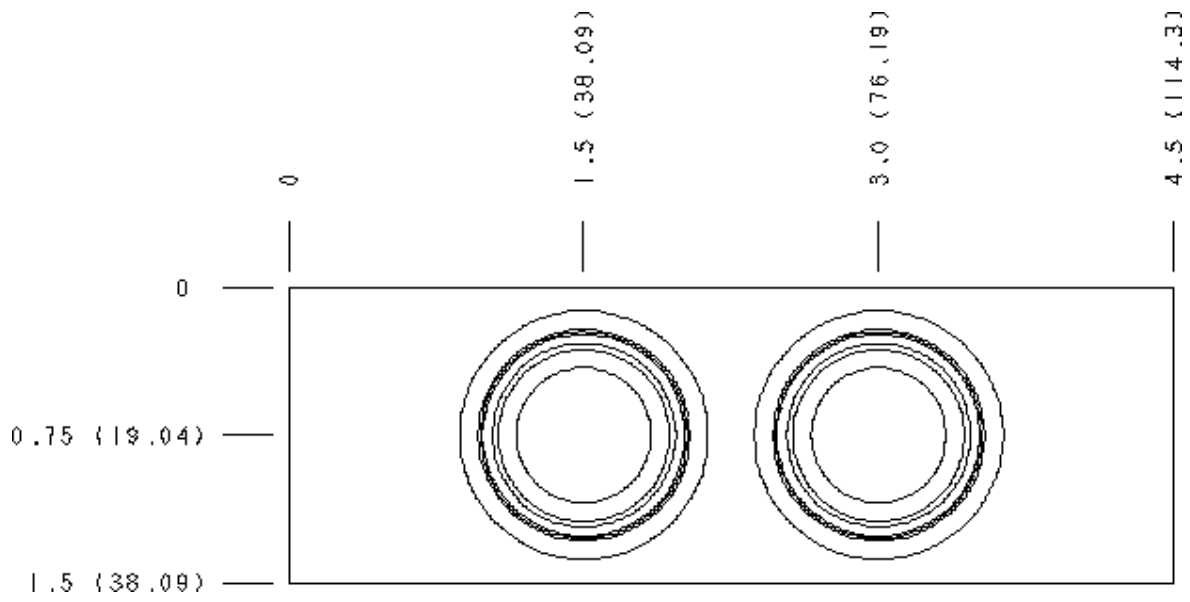

### Face 5

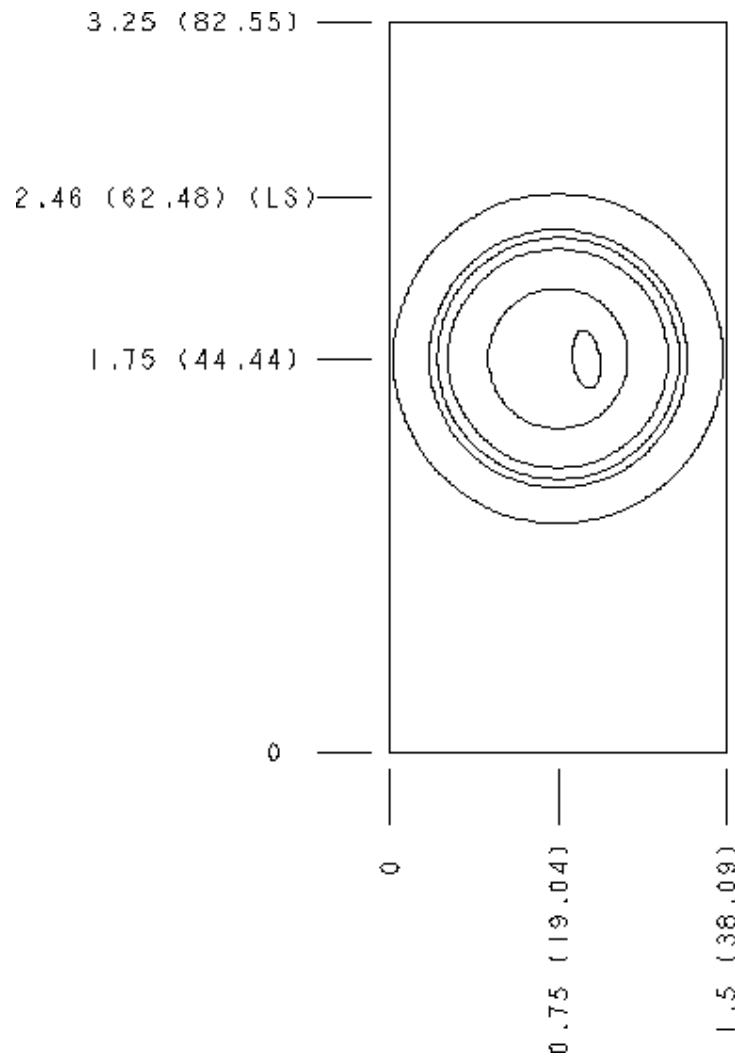

# Face 6

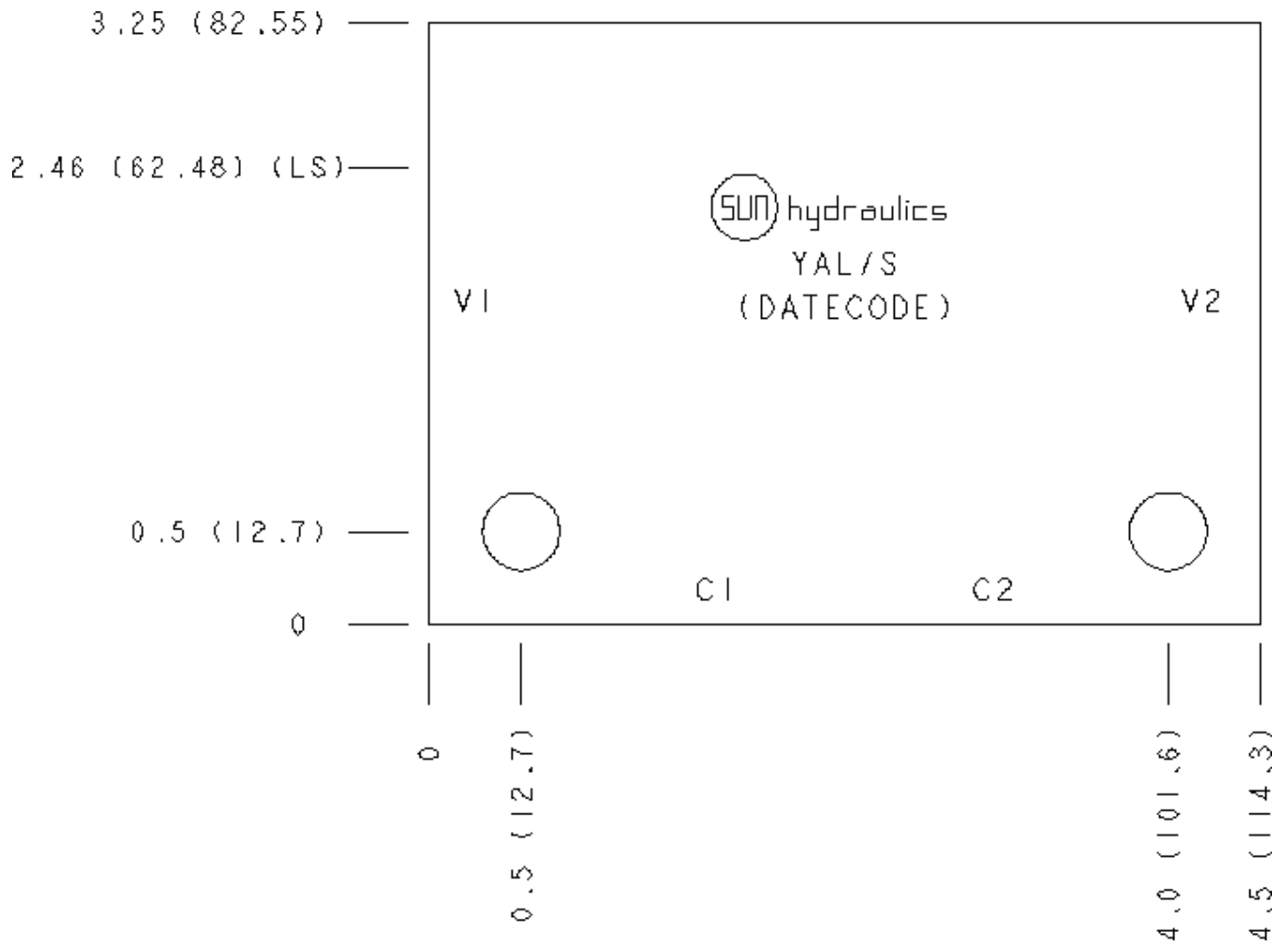

### Face 7

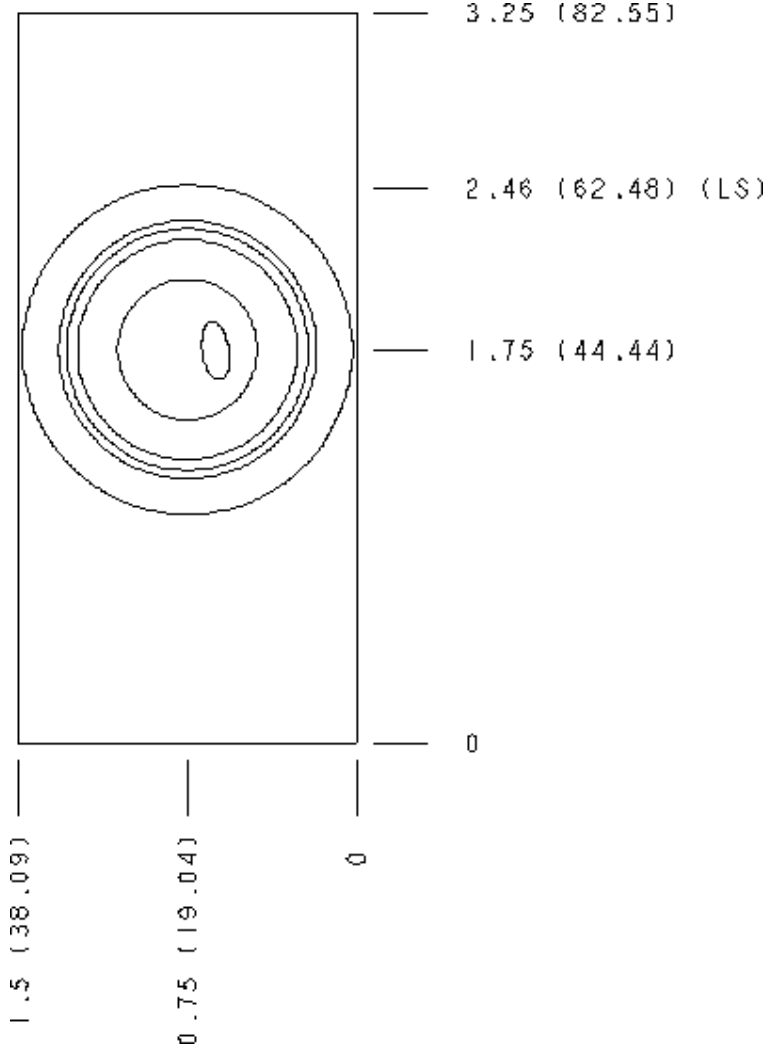

### Face 10

