

# PRESSURE SWITCHES SW-02-4-20



## FEATURES:

- Economical
- High Pressure Ratings
- Wide Adjustment Range
- Low Differential
- Graduated Micrometer Adjustment
- Compact Design
- Locking nut for panel mount

## APPLICATIONS:

- Automated Circuit Control
- System Alarm
- Pilot Light Activation
- System Overload Protection

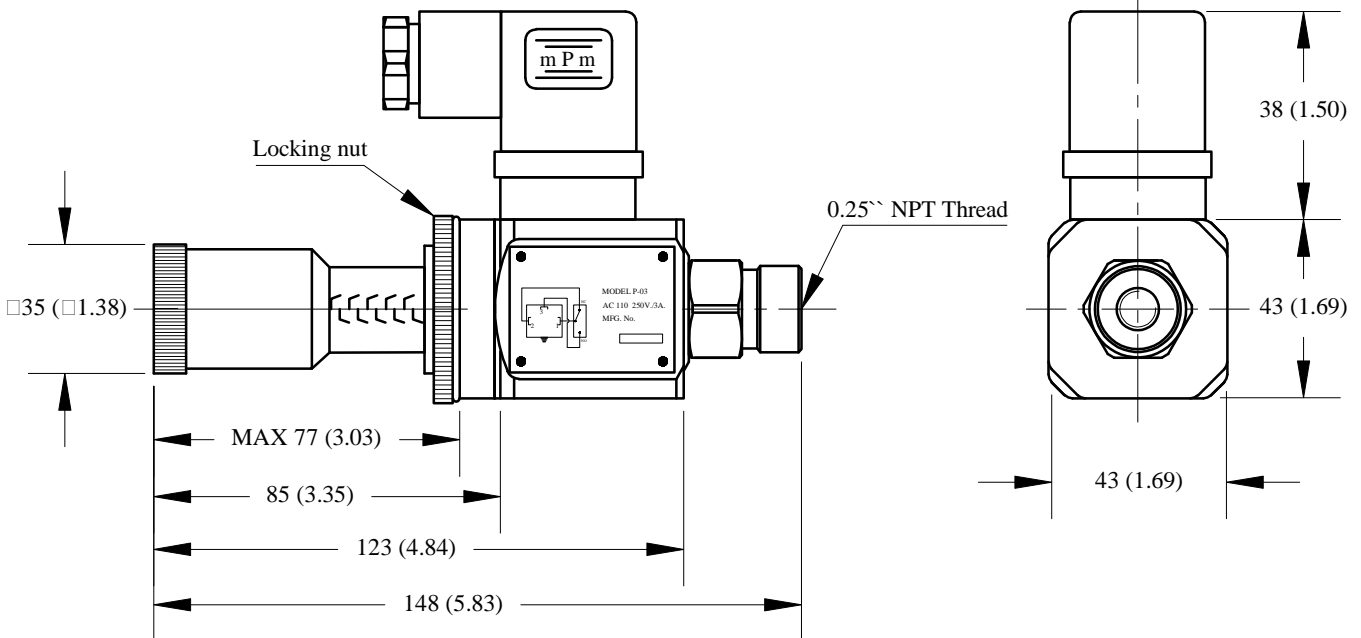
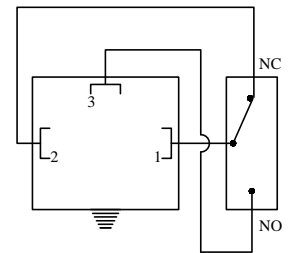
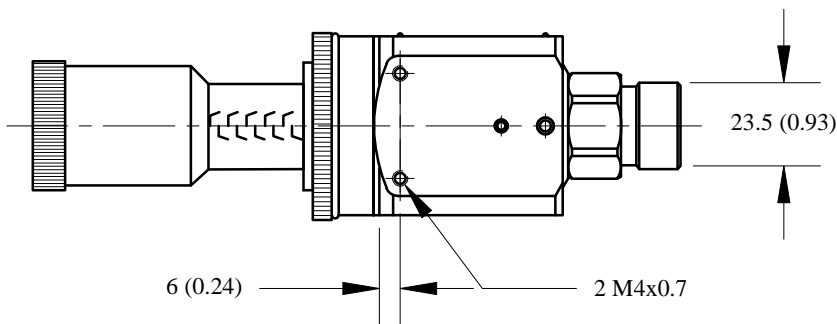

Model	Valve Size	Pressure Range	Pressure Difference	Electrical Rating
SW-02 4 20	1/4"	400 - 5000 PSI	at 400 PSI: 115 - 145 PSI at 5000 PSI: 215 - 290 PSI	DC 24V AC 110-250V/3A