

**TECHNICAL DATA**

Body Type	Line mount
Interface	None
Body Features	Ninety degree with gauge port
Mounting Hole Diameter	.41 in.
Mounting Hole Depth	Through
Mounting Hole Quantity	2
Open Cavities	1
Cavity	T-23A
Port Size	SAE 16
Model Weight	3.16 lb.

**NOTES**

**Important:** Carefully consider the maximum system pressure. The pressure rating of the manifold is dependent on the manifold material, with the port type/size a secondary consideration. Manifolds constructed of aluminum are not rated for pressures higher than 3000 psi (210 bar), regardless of the port type/size specified.

**PORT DESIGNATORS**

Modifiers	Ports
PAM	Ports 1 & 2: SAE 16; Port 3: SAE 12; Port 4: SAE 6; Gage Port: 1/4" NPTF;

**CONFIGURATION OPTIONS**

Model Code Example: PAM

**MODIFIER**

- 6061-T651 Aluminum, Buna-N
- /S 65-45-12 Ductile Iron, Buna-N, Blackened

**MANIFOLD FACES**

**FACE GRID**



5	6	7	8
9	10	11	12

**Face 2**

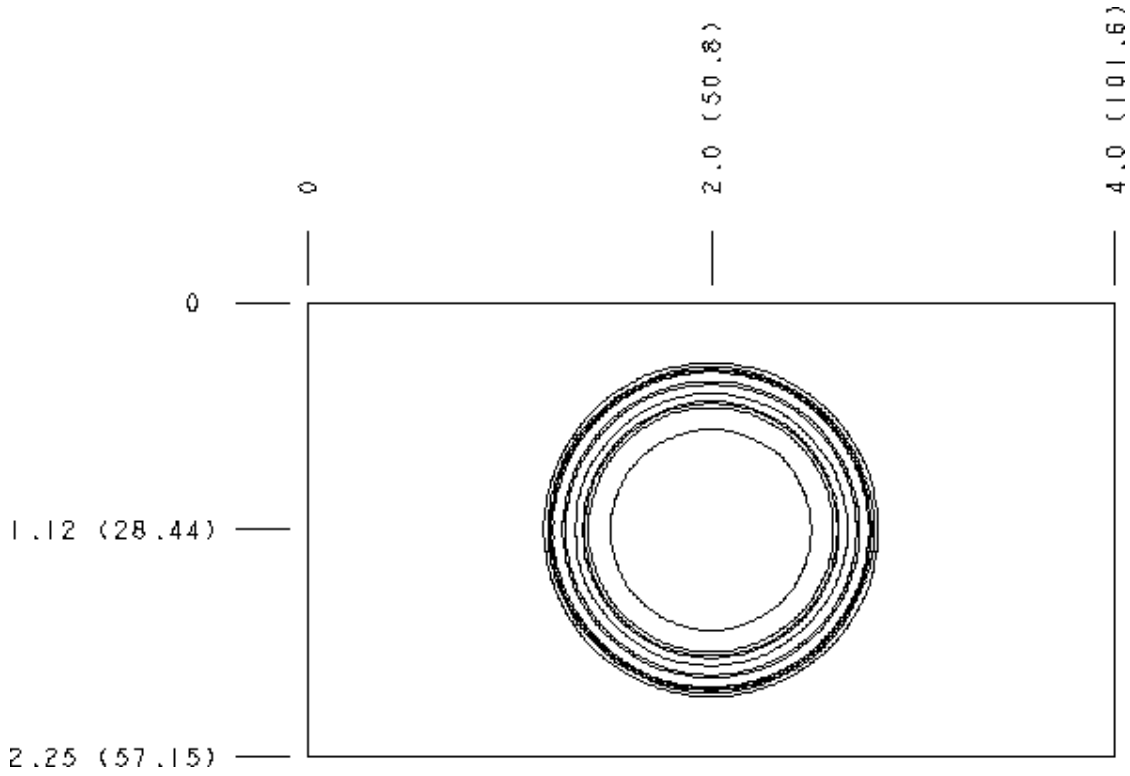

### Face 5

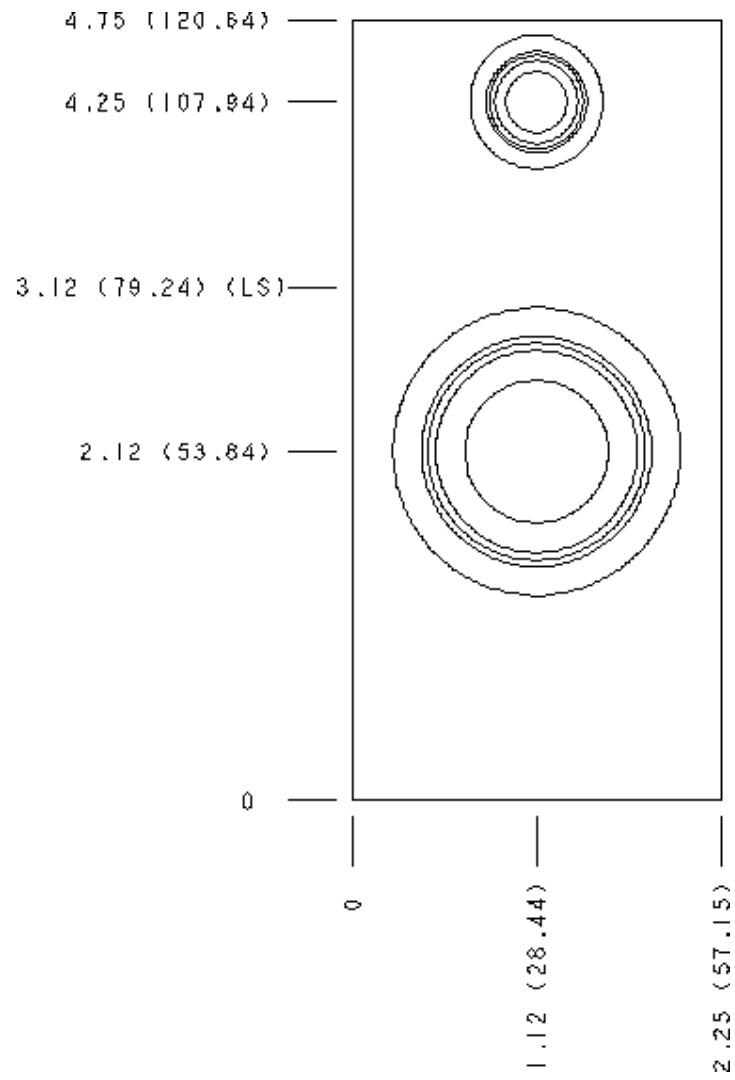

# Face 6

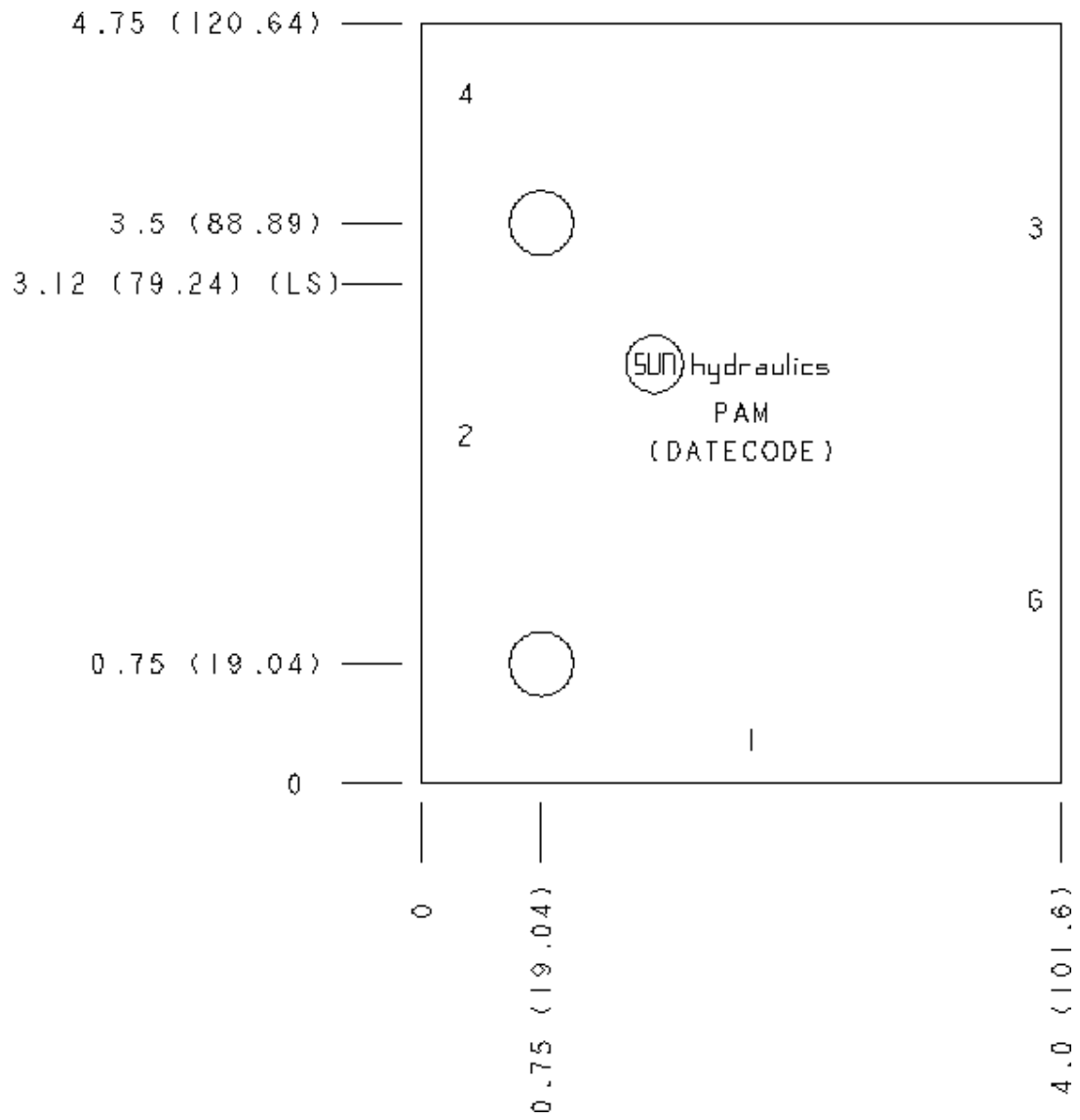

# Face 7

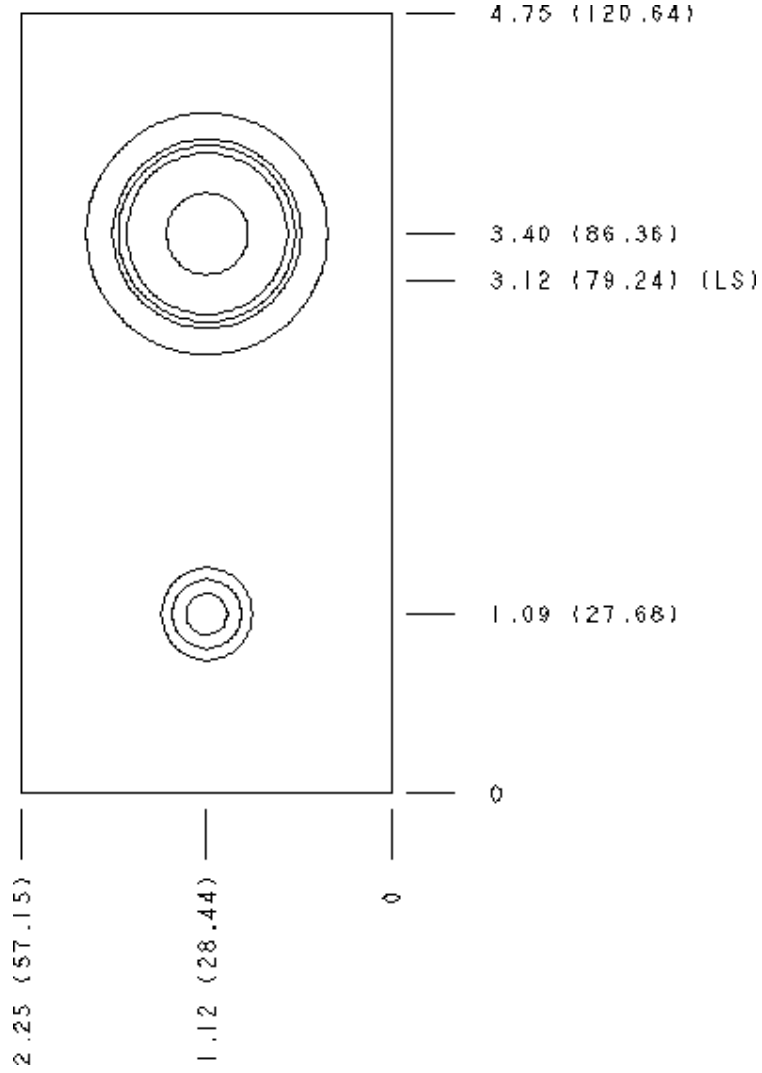

# Face 10

