

FIK In-Tank Filters

Working Pressures to: 145 *psi*
1000 kPa
10 bar

Rated Static Burst to: 217 *psi*
1500 kPa
15 bar

Flow Range to: 211 *gpm*
800 l/min



Features

FIK in-tank filters are economical, space-saving units with simple screw-on covers, ideal for low pressure in-tank applications. This is a heavy-duty filter, with die cast aluminum head and steel canister.

The head (and inlet) sit above the tank, with the housing in the tank. Element flow is outside to inside.

Three service indicators are available: pressure gauge, visual indicator, and electrical indicator. Optional air breathers are also available.

FIK filter assemblies are provided from the factory with cellulose media. Replacement cartridges are offered in a range of media types and performance ratings.

Beta Rating

- Performance to $\beta_{10}=75$

Porting Sizes

- SAE-8, -12, -16 and -20 (low flow)
- SAE-16, -20, -24 O-Ring and 2" SAE 4-Bolt Flange (high flow)

Standard Bypass Ratings

- 22 *psi* / 150 kPa / 1.5 bar

Operating Temperatures

- -4°F to 194°F / -20°C to 90°C

Collapse Ratings

- 145 *psid* / 1000 kPa / 10 bar

Assembly - Side View

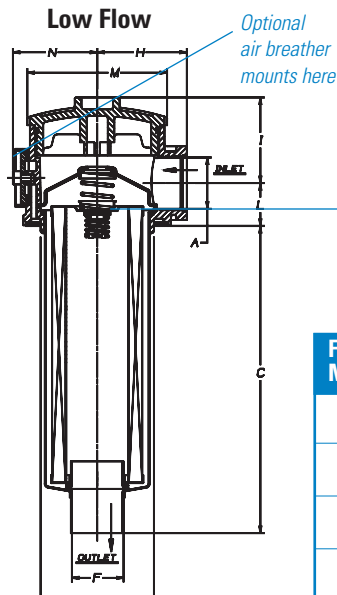

Bypass Valve is an integral part of the replacement filter.

for: Return Lines
Side Loop Systems
Fluid Conditioning Systems
Process Systems
Case Drains
Cooling Circuits
Lube Oil Systems

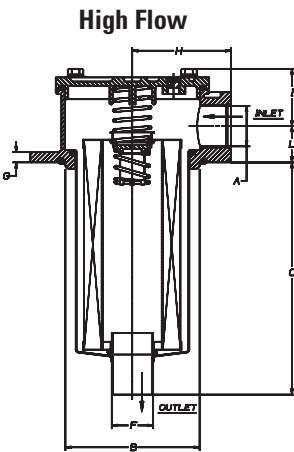

FIK Model	K030319	K040811	K040812	K040813	K040799	K051204	K070248	K070249	K070250
A	½-inch SAE O-Ring	¾-inch SAE O-Ring	1-inch SAE O-Ring	1¼-inch SAE O-Ring	1-inch SAE O-Ring	1¼-inch SAE O-Ring	1½-inch SAE O-Ring	2-inch SAE 4-Bolt Flange	2-inch SAE 4-Bolt Flange
B	2.4 inches 60mm	3.4 inches 89mm	3.4 inches 86mm	3.4 inches 86mm	3.54 inches 90mm	5.2 inches 131mm	6.9 inches 175mm	6.8 inches 174mm	6.8 inches 174mm
C	7.2 inches 184mm	4.1 inches 104mm	5.9 inches 150mm	9.3 inches 235mm	5.7 inches 145mm	9 inches 230mm	9.5 inches 242mm	11.7 inches 297mm	15.9 inches 405mm
D1	3.3 inches 84mm	4.4 inches 112mm	4.4 inches 112mm	4.4 inches 112mm	4.52 inches 115mm	6.9 inches 175mm	8.66 inches 220mm	8.66 inches 220mm	8.66 inches 220mm
D2	3.46 inches 88mm	4.56 inches 116mm	4.56 inches 116mm	4.56 inches 116mm	NA	NA	NA	NA	NA
E	0.4 inches 10mm	0.43 inches 11mm	0.43 inches 11mm	0.43 inches 11mm	0.33 inches 8.4mm	0.4 inches 10.5mm	0.4 inches 10.5mm	0.4 inches 10.5mm	0.4 inches 10.5mm
F	0.87 inches 22mm	1.1 inches 28mm	1.1 inches 28mm	1.6 inches 40mm	1.1 inches 28mm	1.57 inches 40mm	1.97 inches 50mm	2.5 inches 63.5mm	2.5 inches 63.5mm
G	NA	0.47 inches 42mm	0.47 inches 42mm	0.47 inches 42mm	0.4 inches 10mm	0.4 inches 10mm	0.4 inches 10mm	0.4 inches 10mm	0.4 inches 10mm
H	1.9 inches 48mm	2.67 inches 68mm	2.67 inches 68mm	2.67 inches 68mm	2.6 inches 66mm	3.7 inches 95mm	4.7 inches 119mm	4.7 inches 119mm	4.7 inches 119mm
I	1.85 inches 47mm	2.56 inches 65mm	2.56 inches 65mm	2.56 inches 65mm	1.7 inches 43mm	2.1 inches 53mm	2.5 inches 64mm	2.5 inches 64mm	2.5 inches 64mm
L	0.82 inches 21mm	1.26 inches 32mm	1.26 inches 32mm	1.26 inches 32mm	1.1 inches 28mm	1.4 inches 35mm	1.6 inches 41mm	1.6 inches 41mm	1.6 inches 41mm
M	2.9 inches 74mm	4.2 inches 106mm	4.2 inches 106mm	4.2 inches 106mm	NA	NA	NA	NA	NA
N	2.4 inches 60mm	3.4 inches 86mm	3.4 inches 86mm	3.4 inches 86mm	NA	NA	NA	NA	NA
Weight	1.8 lbs. 0.8 kg.	2.1 lbs. 0.95 kg.	3.2 lbs. 1.45 kg.	4.1 lbs. 1.86 kg.	2.1 lbs. 0.95 kg.	7.0 lbs. 3.2 kg.	10.0 lbs. 4.5 kg.	13.1 lbs. 5.9 kg.	18.6 lbs. 8.4 kg.

All dimensions above are shown in inches [millimeters]

Head - Top View

FIK-030319, FIK-040811,
FIK-040812, FIK-040813

FIK-070248, FIK-070249,
FIK-070250

FIK-051204

FIK-040799

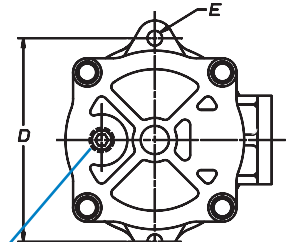
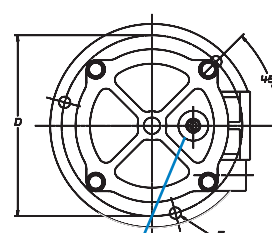
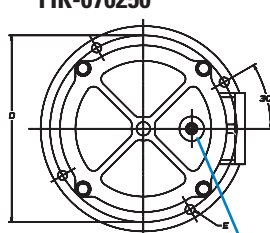
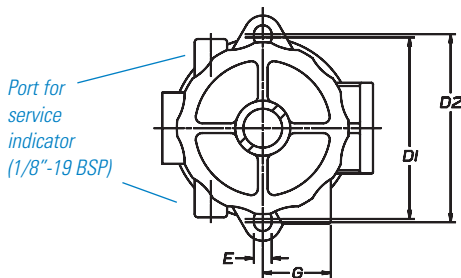

Port for Service Indicator (1/8" - 19 BSP)

FIK Assemblies & Service Parts

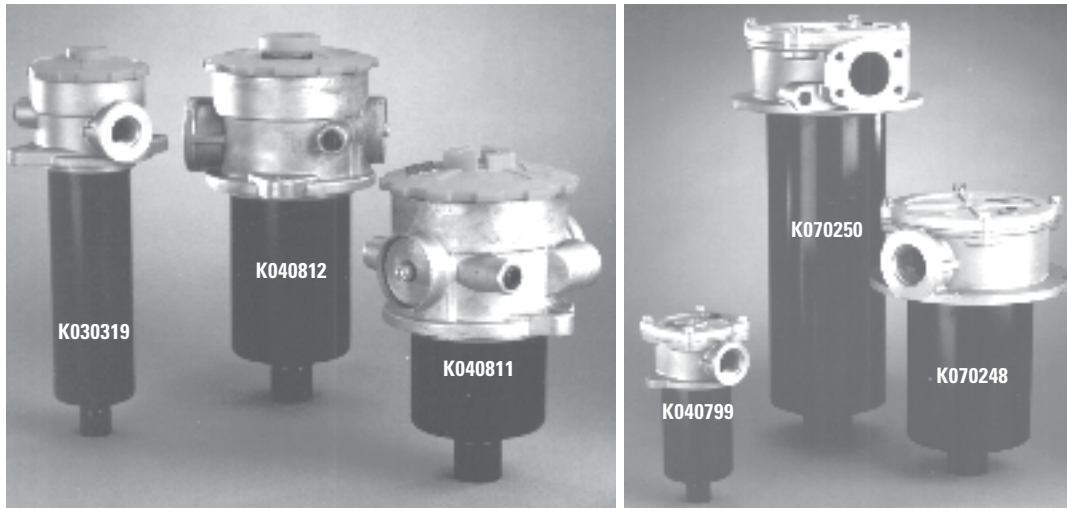

FIK Filter Assemblies

Port Size	Bypass Rating*	Service Indicator	Beta Rating	FIK Assembly Model	Provided with this Element	Flow Range
SAE-8 O-Ring	22 psi / 150 kPa / 1.5 bar	Port Available	$\beta_{10} = 2$	K030319	P171839	10 gpm
SAE-12 O-Ring	22 psi / 150 kPa / 1.5 bar	Port Available	$\beta_{10} = 2$	K040811	P171527	14 gpm
SAE-16 O-Ring	22 psi / 150 kPa / 1.5 bar	Port Available	$\beta_{10} = 2$	K040812	P171533	25 gpm
SAE-20 O-Ring	22 psi / 150 kPa / 1.5 bar	Port Available	$\beta_{10} = 2$	K040813	P171840	40 gpm
1" SAE O-Ring	22 psi / 150 kPa / 1.5 bar	Port Available	$\beta_{10} = 2$	K040799	P171533	20 gpm
1¼" SAE O-Ring	22 psi / 150 kPa / 1.5 bar	Port Available	$\beta_{10} = 2$	K051204	P171539	40 gpm
1½" SAE O-Ring	22 psi / 150 kPa / 1.5 bar	Port Available	$\beta_{10} = 2$	K070248	P171557	60 gpm
2" SAE 4-Bolt Flange	22 psi / 150 kPa / 1.5 bar	Port Available	$\beta_{10} = 2$	K070249	P171575	120 gpm
2" SAE 4-Bolt Flange	22 psi / 150 kPa / 1.5 bar	Port Available	$\beta_{10} = 2$	K070250	P171581	211 gpm

Note

* Bypass valve is integral part of replacement filter

Replacement Element Choices

Media Type	Beta Rating	Fits Assembly Model:			
		K030319	K040811	K040812	K040813
Synteq®	$\beta_{10} = 75$	P171845	P171525	P171531	P171846
Synteq®	$\beta_{25} = 75$		P171526	P171532	P171843
Cellulose	$\beta_{10} = 2$	P171839	P171527	P171533	P171840
Cellulose	$\beta_{25} = 2$		P171528	P171534	P171837
Wiremesh	60 Absolute		P171529	P171535	P171834
Wiremesh	90 Absolute		P171524	P171530	



Service Indicators

Pressure Gauges P171956

G 1/8
(center back)



P171953

G 1/8
(bottom mount)

-14.5 to 72 *psi*
-1 to +5 bar

AC/DC Electrical Indicator P171966

17 *psi*
1.2 bar

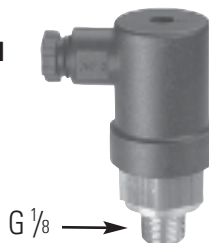

G 1/8 →

Visual Indicator P171958

17 *psi*
1.2 bar



G 1/8 →

Optional Air Breathers

Part No.	Beta Rating	Fits Assembly Models:
P172434	10µm	K040811, K040812, K040813
P173330	10µm	K030319

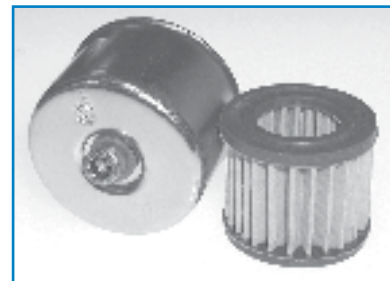

Optional air breather is easily installed on filter head.

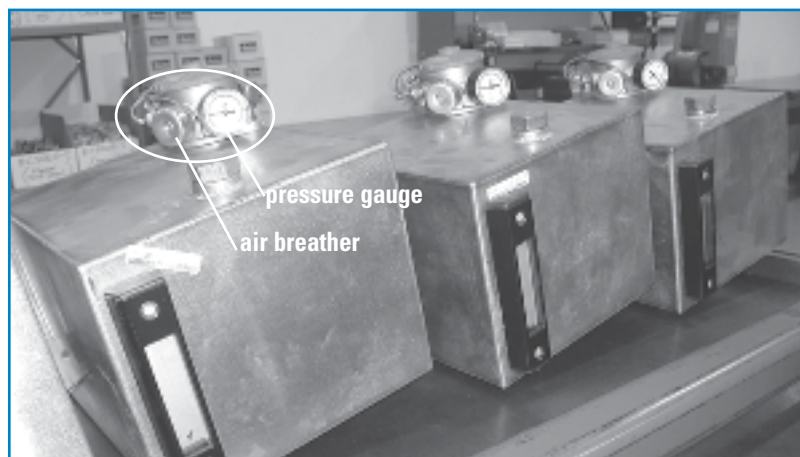

pressure gauge
air breather

FIK Application

FIK in-tank return filters are used on small reservoirs to clean the oil before it goes into vehicles. Shown here, the P171956 pressure gauge and P173330 air breather are installed on the filter heads.

Replacement Element Choices

Media Type	Beta Rating	Fits Assembly Model:				
		K040799	K051204	K070248	K070249	K070250
Synthetic	β ₁₀ =75	P171531	P171537	P171555	P171573	P171579
Synthetic	β ₂₅ =75	P171532	P171538	P171556	P171574	P171580
Cellulose	β ₁₀ =2	P171533	P171539	P171557	P171575	P171581
Cellulose	β ₂₅ =2	P171534	P171540	P171558	P171576	P171582
Wiremesh	60 Absolute	P171535	P171541			P171583
Wiremesh	90 Absolute	P171530	P171536		P171572	

Performance Data

For a full explanation of how our performance curves were derived, see page 150.

K030319 Assembly

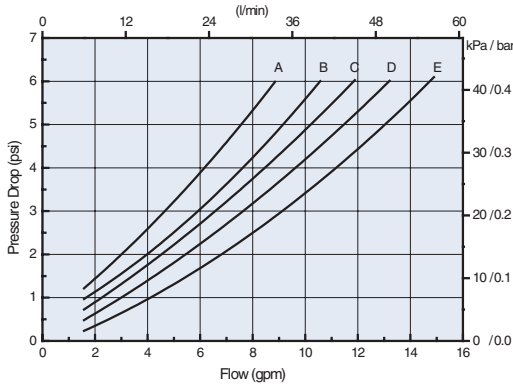

- Service Element Part Numbers
 A. P171845 (Synthetic)
 C. P171839* (Cellulose)
 D. P171836 (Cellulose)
 E. P171833, P171830 (Wiremesh)

K040811 Assembly

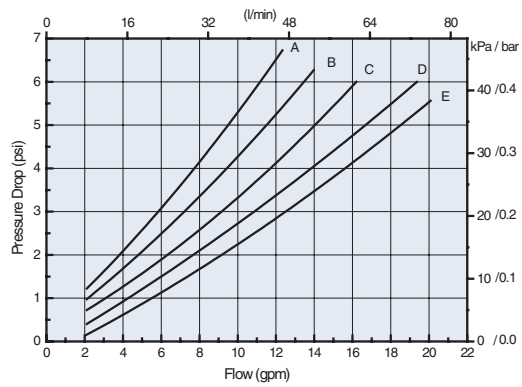

- Service Element Part Numbers
 A. P171525 (Synthetic)
 B. P171526 (Synthetic)
 C. P171527* (Cellulose)
 D. P171528 (Cellulose)
 E. P171529, P171524 (Wiremesh)

K040812 Assembly

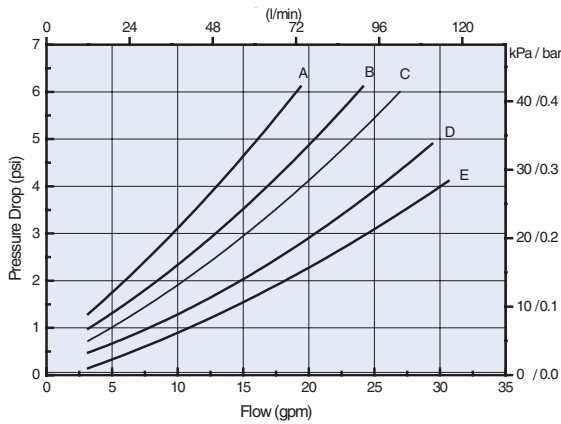

- Service Element Part Numbers
 A. P171531 (Synthetic)
 B. P171532 (Synthetic)
 C. P171533* (Cellulose)
 D. P171534 (Cellulose)
 E. P171535, P171530 (Wiremesh)

K040813 Assembly

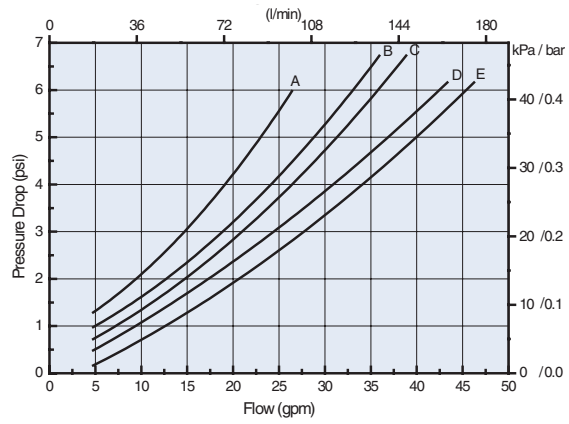

- Service Element Part Numbers
 A. P171846 (Synthetic)
 B. P171843 (Synthetic)
 C. P171840* (Cellulose)
 D. P171837 (Cellulose)
 E. P171834, P171831 (Wiremesh)



Performance Data

For a full explanation of how our performance curves were derived, see page 150.

K040799 Assembly

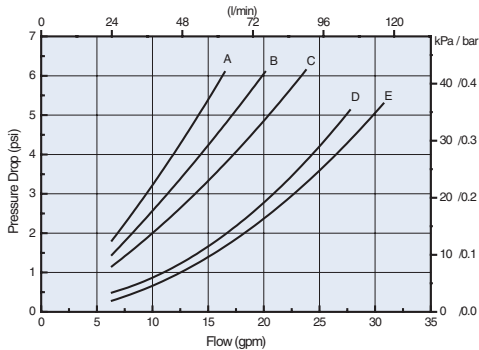

- Service Element Part Numbers
- A. P171531 (Synthetic)
 - B. P171532 (Synthetic)
 - C. P171533* (Cellulose)
 - D. P171534 (Cellulose)
 - E. P171535, P171530 (Wiremesh)

K051204 Assembly

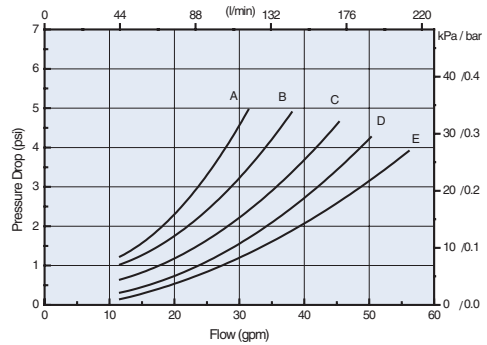

- Service Element Part Numbers
- A. P171537 (Synthetic)
 - B. P171538 (Synthetic)
 - C. P171539* (Cellulose)
 - D. P171540 (Hvy Duty Cellulose)
 - E. P171541, P171536 (Wiremesh)

K070249 Assembly

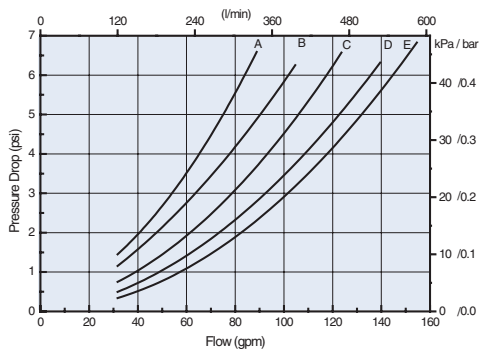

- Service Element Part Numbers
- A. P171573 (Synthetic)
 - B. P171574 (Synthetic)
 - C. P171575* (Cellulose)
 - D. P171576 (Cellulose)
 - E. P171572 (Wiremesh)

K070250 Assembly

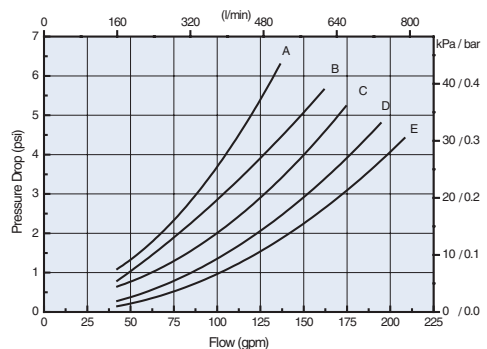

- Service Element Part Numbers
- A. P171579 (Synthetic)
 - B. P171580 (Synthetic)
 - C. P171581* (Cellulose)
 - D. P171582 (Cellulose)
 - E. P171583 (Wiremesh)

K070248 Assembly

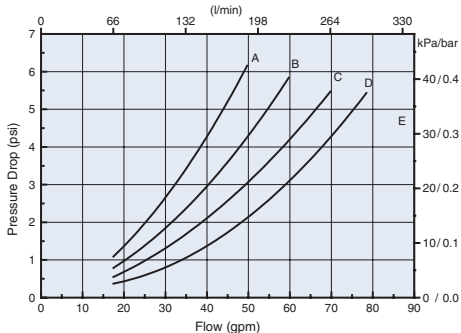

- Service Element Part Numbers
- A. P171555 (Synthetic)
 - B. P171556 (Synthetic)
 - C. P171557* (Cellulose)
 - D. P171558 (Cellulose)