

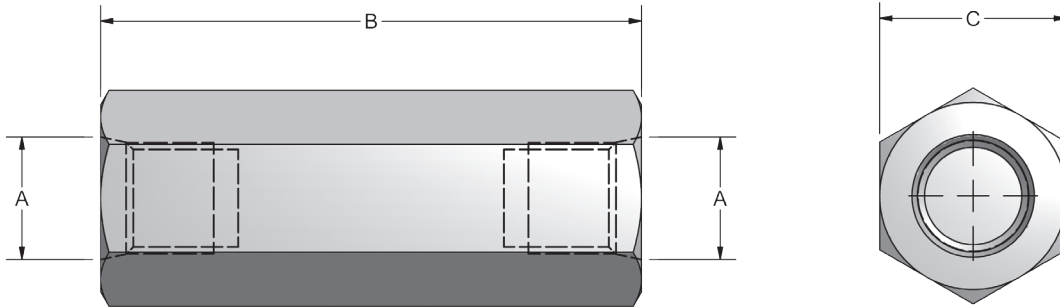

NPTF & SAE Connections  
 Carbon Steel with Zinc Chromate Plating (RoHS Compliant)  
 Available in 7 PSI & 65 PSI Spring Cracking Pressures  
 Metal to Metal Seat  
 Hardened Poppet  
 Temperature Range -4°F to +176°F



CHECK VALVES						
A		B	C	MAX PSI	MAX FLOW GPM	WEIGHT (LBS)
NPTF	SAE					
1/4"	#4	2.17	.75	5700	4	.2
3/8"	N/A	2.68	.95	5700	8	.4
N/A	#6	2.28	.75	5700	8	.2
1/2"	N/A	2.95	1.06	5700	13	.5
N/A	#8	2.72	.95	5700	13	.4
3/4"	#12	3.48	1.38	5700	23	1.0
1"	#16	4.33	1.61	5000	40	1.6
1 1/4"	#20	4.72	2.17	5000	50	3.4
1 1/2"	#24	5.43	2.56	5000	80	5.6
2"	#32	5.43	2.95	4500	110	6.7

**Model Code Breakdown**

C N 1/2 - 1 - 7

Valve Series •

Thread Type •

N	NPTF Pipe Thread
S#	SAE Straight Thread

Thread Size •

Example	N1/2
	S#8

Cracking Pressure

7	7 PSI
65	65 PSI

Material

1	Carbon Steel
---	--------------

