

T (momentary/twist operation) control kit

Functional Group:

Products : Accessories : Cartridge Control Options and Kits : Twist and Lock Manual Override

Model:

991-225

Product Description

The Twist/Lock manual override is a rotary, hand-actuated device for use on Sun's full flow solenoid valves. The hand knob is constructed of a reinforced plastic for durability, heat resistance and stability in varying environmental conditions and is suitable for operation with a gloved hand. The override assembly incorporates a sealed-construction design thereby preventing the introduction of debris and other damaging contamination. Once installed on a Sun solenoid valve, the override feature allows the operator to manually shift the de-energized valve. Solenoid cartridges may be ordered in this configuration by specifying a T, L, or D control in the cartridge model number. Sun kits for field conversion are also available.

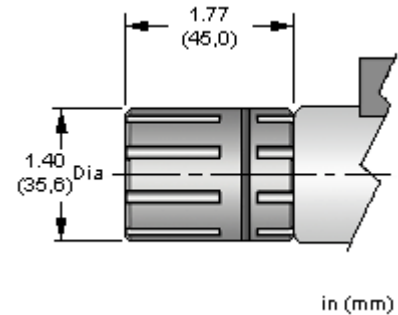

Kit Description

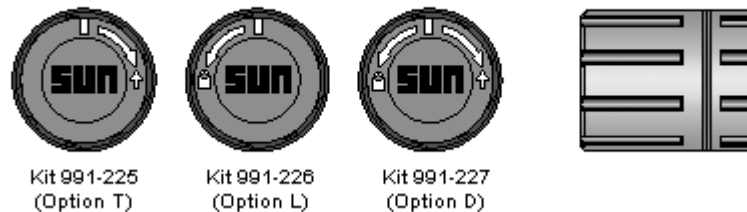

Related Information

[Instruction Sheet for Kits 991-225, 991-226, and 991-227](#)

Technical Features

- The momentary/twist override option "T" allows the operator to momentarily shift the valve by twisting the manual override clockwise and releasing. Once released, the valve returns to its de-energized position.

Technical Data

	U.S. Units	Metric Units
Model Weight	1.11 lb.	0.50 kg.
Description	Momentary/Twist Operation (Option T)	
For Cartridge Models	DAAL, DAAM, DBAL, DBAM, DTDA, DMDA, DNDA, DLDA, DWDA	
Material	Black plastic	

Option Selection:

991-225

All rights reserved.

[Terms and Conditions](#) - [Statement of Privacy](#)