

Flat Face



Overview:

"A" Series or Premier Series offers higher pressure ratings, superior flow ratings, lower pressure drop compared to FIRG Series or competitors products.

Applications:

Flat Face couplers are specifically designed for applications needing no-leak performance. The mating faces are easily cleaned before connecting, making it the ideal solution for limiting contamination in a hydraulic circuit. The design allows applications involving high pressure impulses in agriculture equipment, mobile construction equipment and general industrial plants. Non-Spill design avoids fluid loss in connection & disconnection.

Options:

- Seals: Viton, EPDM, & Kalrez.
- Threads: NPT, SAE, ORFS, JIC
- Multiple mounting options

Series: "A" Premier

Interchange: ISO 16028 Flat Face

"A" series couplings are in accordance for Interchangeability and performances of ISO 16028. The interchangeability of size 10 is also in accordance with NFPA T3.20.15 (HTMA).

Interchange: Parker FEM, Aeroquip FD89, Faster 2FFI, Snap-Tite 74

- Seals: Nitrile & Teflon anti-extrusion
- Nipple: Hardened steel reduces brinnelling
- 12 to 20 balls to increase the male bearing points & decrease the brinelling effect
- Modular structure for multiple port option
- Lock system stops unwanted disconnect
- Exceeds Impulse test of ISOA-7241 test

Stucchi Series	Nominal Size Inches	ISO Size MM	MAX OPERATING PRESSURE COUPLED bar	MAX OPERATING PRESSURE COUPLED PSI
A4	1/8	5.0	420	6000
A7	1/4	6.3	420	6000
A9	3/8	10.0	350	5000
A13	1/2	12.5	330	4714
A15	5/8	16.0	330	4714
A17	3/4	19.0	330	4714
A21	1	25.0	300	4286
A25	1 1/4	27.0	300	4286
A30	1 1/2	31.5	270	3857

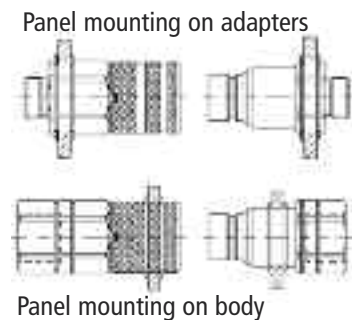
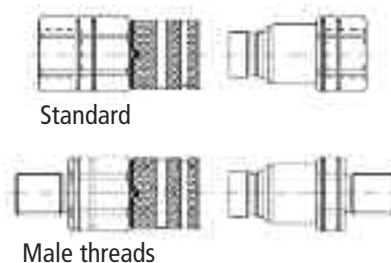

Item	Body Size	Size (MM)	A inch	B (mm)	C (mm)	D (mm)	E (mm)	F (mm)	G (mm)	I (mm)
A4	1/8"	5	1/8"	36.5	20	40	68.5	18.5	20.5	11
A7	1/4"	6.3	1/4"	48	28	53	90.5	24	29	16.2
A9	3/8"	10	3/8"	60	32	64.5	109	29	32	19.8
A9	3/8"	10	1/2"	62.5	32	69.5	116.5	29	32	19.8
A13	1/2"	12.5	1/2"	68	38	76.5	127.5	40	40	24.5
A13	1/2"	12.5	3/4"	70.5	38	83.5	137	40	40	24.5
A15	5/8"	16	3/4"	73	42	83.5	139.5	38.5	45	27
A17	3/4"	19	1"	84	48	98.5	161	50	50	30
A21	1"	21	1 1/4"	90	55	105	173	60	60	36
A25	1 1/4"	25	1 1/4"	105	65	125.1	206.9	59.8	65	44.1
A30	1 1/2"	31.5	1 1/2"	111	80	132.5	215	70	82	57

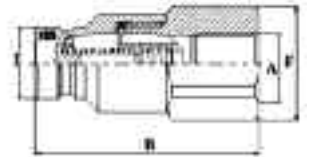
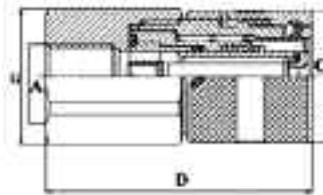
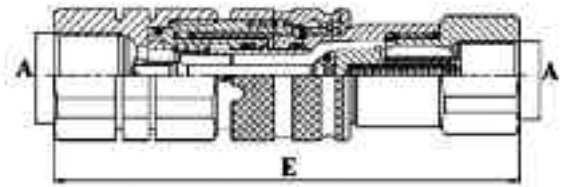
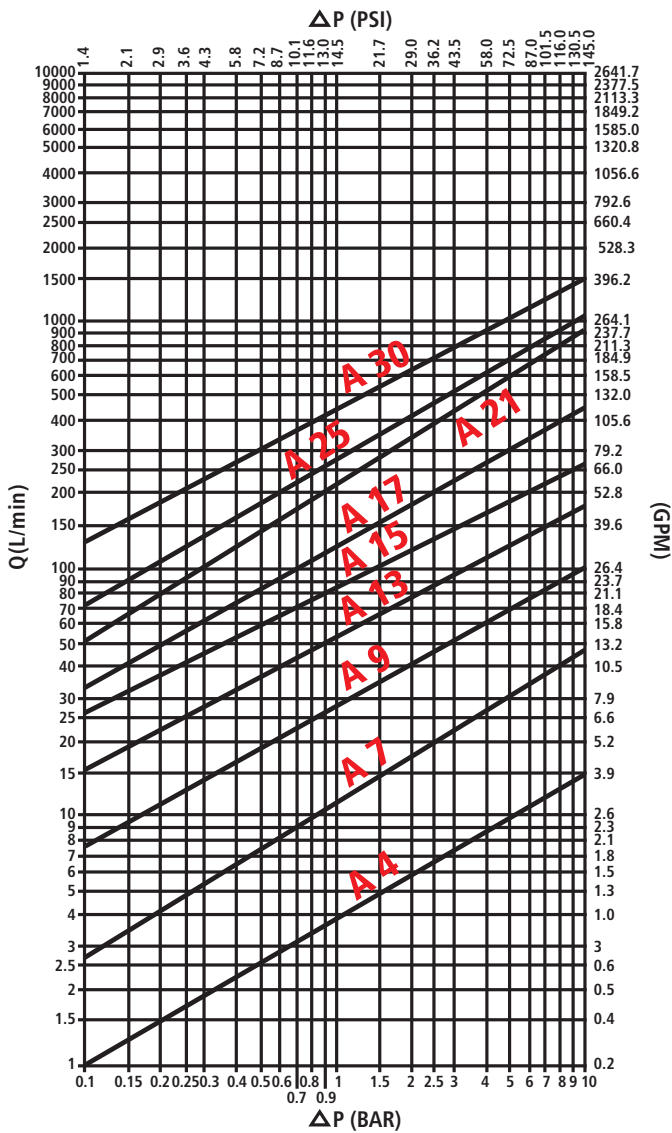

Panel mount options available upon request.

ISO 16028 Interchange Couplings Flat Face



Coupler



Nipple



Stucchi

Interchange: Parker FEM Series, Aeroquip FD89
ISO 16028 Interchange: NPT Thread

Part	Body Size	Port Size	Thread Type	Order Code	Part Description
Coupler	1/8	1/8	NPT	801301002	F. A4 1/8 NPT
Nipple	1/8	1/8	NPT	801301003	M. A4 1/8 NPT
Coupler	1/4	1/4	NPT	801301004	F. A7 1/4 NPT
Nipple	1/4	1/4	NPT	800801001	M. FIRG 14 NPT
Coupler	3/8	3/8	NPT	801301006	F. A9 3/8 NPT
Nipple	3/8	3/8	NPT	801301005	M. A9 3/8 NPT
Coupler	3/8	1/2	NPT	801301008	F. A9 1/2 NPT
Nipple	3/8	1/2	NPT	801301007	M. A9 1/2 NPT
Coupler	1/2	1/2	NPT	801301010	F. A13 1/2 NPT
Nipple	1/2	1/2	NPT	801301009	M. A13 1/2 NPT
Coupler	1/2	3/4	NPT	801301012	F. A13 3/4 NPT
Nipple	1/2	3/4	NPT	801301011	M. A13 3/4 NPT
Coupler	5/8	3/4	NPT	801301014	F. A15 3/4 NPT
Nipple	5/8	3/4	NPT	801301013	M. A15 3/4 NPT
Coupler	5/8	1	NPT	801301020	F. A15 1" NPT
Nipple	5/8	1	NPT	801301019	M. A15 1" NPT
Coupler	3/4	3/4	NPT	801301030	F. A17 3/4 NPT
Nipple	3/4	3/4	NPT	801301031	M. A17 3/4 NPT
Coupler	3/4	1	NPT	801301000	F. A17 1" NPT
Nipple	3/4	1	NPT	801301001	M. A17 1" NPT
Coupler	1	1	NPT	801301028	F. A21 1" NPT
Nipple	1	1	NPT	801301029	M. A21 1" NPT
Coupler	1	1 1/4	NPT	801301016	F. A21 11/4 NPT
Nipple	1	1 1/4	NPT	801301015	M. A21 11/4 NPT
Coupler	1 1/4	1 1/4	NPT	801301034	F. A25 11/4 NPT
Nipple	1 1/4	1 1/4	NPT	801301035	M. A25 11/4 NPT
Coupler	1 1/2	1 1/2	NPT	801301018	F. A30 11/2 NPT
Nipple	1 1/2	1 1/2	NPT	801301017	M. A30 11/2 NPT

Skid Steer Applications: Custom Ports
Interchange: Parker FEM Series, Aeroquip FD89
ISO 16028 Interchange: -Male Threads

Part	Body Size	Port Size	Thread Type	Order Code	Part Description
Coupler	3/8	1/2	JIC Bulkhead	801306014	F. A9 1/2 JIC BH
Nipple	3/8	1/2	JIC Bulkhead	801306015	M. A9 1/2 JIC BH
Coupler	1/2	5/8	JIC Bulkhead	803306000	F. A13D 5/8 JIC BH
Nipple	1/2	5/8	JIC Bulkhead	801306017	M. A13 5/8 JIC BH
Coupler	1/2	3/4	JIC Bulkhead	801306024	F. A13 3/4 JIC BH
Nipple	1/2	3/4	JIC Bulkhead	801306025	M. A13 3/4 JIC BH
Coupler	3/4	3/4	JIC Bulkhead	801306028	F. A17 3/4 JIC BH
Nipple	3/4	3/4	JIC Bulkhead	801306029	M. A17 3/4 JIC BH
Coupler	1/2	5/8	JIC INT	803706002	F. A13 TI 5/8 JIC INT
Nipple	1/2	5/8	JIC INT	803706003	M. A13 TI 5/8 JIC INT
Coupler	1/2	5/8	ORFS Bulkhead	803313000	F. A13D 5/8 ORFSBH
Nipple	1/2	5/8	ORFS Bulkhead	801313001	M. A13 5/8 ORFSBH
Coupler	1/2	3/4	ORFS Bulkhead	803313002	F. A13D 3/4 ORFSBH
Nipple	1/2	3/4	ORFS Bulkhead	801313005	M. A13 3/4 ORFSBH
Coupler	1/2	1	ORFS Bulkhead	803313004	F. A13D 1" ORFSBH
Nipple	1/2	1	ORFS Bulkhead	801313007	M. A13 1" ORFSBH

Interchange: Parker FEM Series, Aeroquip FD89
ISO 16028 Interchange: -SAE Thread

Part	Body Size	Port Size	Thread Type	Order Code	Part Description
Coupler	1/8	1/8	SAE	801304002	F. A4 3/16 SAE
Nipple	1/8	1/8	SAE	801304003	M. A4 3/16 SAE
Coupler	1/4	3/8	SAE	801304004	F. A7 3/8 SAE
Nipple	1/4	3/8	SAE	800804001	M. FIRG 14 3/8 SAE
Coupler	3/8	3/8	SAE	801304006	F. A9 3/8 SAE
Nipple	3/8	3/8	SAE	801304005	M. A9 3/8 SAE
Coupler	3/8	1/2	SAE	801304008	F. A9 1/2 SAE
Nipple	3/8	1/2	SAE	801304007	M. A9 1/2 SAE
Coupler	3/8	5/8	SAE	801304030	F. A9 5/8 SAE
Nipple	3/8	5/8	SAE	801304031	M.A9 5/8 SAE
Coupler	1/2	1/2	SAE	803304004	F. A13 1/2 SAE
Nipple	1/2	1/2	SAE	801304035	M. A13 1/2 SAE
Coupler	1/2	5/8	SAE	801304024	F. A13 5/8 SAE
Nipple	1/2	5/8	SAE	801304025	M. A13 5/8 SAE
Coupler	1/2	3/4	SAE	801304010	F. A13 3/4 SAE
Nipple	1/2	3/4	SAE	801304009	M. A13 3/4 SAE
Coupler	5/8	3/4	SAE	801304012	F. A15 3/4 SAE
Nipple	5/8	3/4	SAE	801304011	M. A15 3/4 SAE
Coupler	3/4	3/4	SAE	801304028	F. A17 3/4 SAE
Nipple	3/4	3/4	SAE	801304029	M. A17 3/4 SAE
Coupler	3/4	1	SAE	801304000	F. A17 1" SAE
Nipple	3/4	1	SAE	801304001	M. A17 1" SAE
Coupler	1	1	SAE	801304038	F. A21 1" SAE
Nipple	1	1	SAE	801304039	M. A21 1" SAE
Coupler	1	1 1/4	SAE	801304014	F. A21 11/4 SAE
Nipple	1	1 1/4	SAE	801304013	M. A21 11/4 SAE
Coupler	1 1/4	1 1/4	SAE	801304042	F. A25 11/4 SAE
Nipple	1 1/4	1 1/4	SAE	801304043	M. A25 11/4 SAE
Coupler	1 1/2	1 1/2	SAE	801304016	F. A30 11/2 SAE
Nipple	1 1/2	1 1/2	SAE	801304015	M. A30 11/2 SAE



Coupler



Nipple

Hand Tool Applications: Special Configuration
Interchange: Parker FEM Series, Aeroquip FD49 Interchange: ISO 16028

Part	Body Size	Port Size	Thread Type	Order Code	Part Description
Coupler	3/8	3/8	Male SAE	803704004	F. A9 3/8 T30 SAE EXT.
Nipple	3/8	3/8	Male SAE	801304037	M.A9 3/8 SAE EXT
Coupler	3/8	1/2	Male SAE	803704006	F. A9 1/2 T30 SAE EXT.
Coupler	3/8	1/2	Male SAE	801304032	F.A9 1/2 SAE EXT
Nipple	3/8	1/2	Male SAE	801304033	M.A9 1/2 SAE EXT
Coupler	3/8	3/8	Female NPT	803601000	F. FIRG 38 T30 NPT
Coupler	3/8	1/2	Female NPT	803601002	F. FIRG 12 T30 NPT

