

# Tube Fittings & Adapters

## MP-FJS Straight 6505 Series

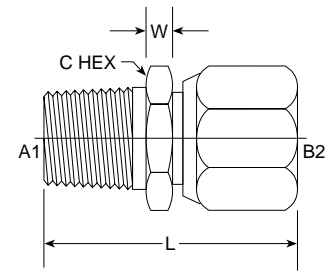

PART NO. SIZE	TUBE O.D.	A1 NPTF	B2 SAE 37	L LGTH	M.M.	W WIDTH	C HEX	C HEX	M.M.	Standard Material From Stock			
										S	FG	SS	B
NEW 6505-02-04	1/4	1/8-27	7/16-20	1.350	34.29	0.360	7/16	0.438	11.13	•		•	
6505-02-05	1/4	1/4-18	7/16-20	1.450	36.83	0.270	9/16	0.562	14.27	•		•	
6505-04-04	1/4	1/4-18	7/16-20	1.410	35.81	0.270	5/8	0.625	15.88	•		•	
6505-04-06	3/8	1/4-18	9/16-18	1.600	40.64	0.270	11/16	0.687	17.45	•		•	
6505-06-06	3/8	3/8-18	9/16-18	1.720	43.69	0.400	3/4	0.750	19.05	•		•	
6505-06-08	1/2	3/8-18	3/4-16	1.730	43.94	0.350	7/8	0.875	22.23	•		•	
6505-06-10	5/8	3/8-18	7/8-14	1.793	45.54	0.380	1	1.000	25.40	•		•	
6505-08-08	1/2	1/2-14	3/4-16	1.910	48.51	0.340	7/8	0.875	22.23	•		•	
6505-08-10	5/8	1/2-14	7/8-14	2.280	57.91	0.470	1	1.000	25.40	•		•	
6505-08-12	3/4	1/2-14	1 1/16-12	2.174	55.22	0.430	1	1.000	25.40	•		•	
6505-12-10	5/8	3/4-14	7/8-14	1.930	49.02	0.340	1 1/16	1.062	26.97	•		•	
6505-12-12	3/4	3/4-14	1 1/16-12	2.270	57.66	0.430	1 1/8	1.125	28.58	•		•	
NEW 6505-12-14	1	3/4-14	1 5/16-12	2.400	60.96	0.390	1 1/4	1.250	31.75	•		•	
6505-12-16	1	1-11 1/2	1 5/16-12	2.550	64.77	0.440	1 1/2	1.500	38.10	•		•	
6505-16-16	1 1/4	1 1/4-11 1/2	1 5/8-12	2.650	67.31	0.400	1 11/16	1.688	42.86	•		•	
6505-20-20	1 1/2	1 1/2-11 1/2	1 7/8-12	2.930	74.42	0.580	2	2.000	50.80	•		•	
6505-32-32	2	2-11 1/2	2 1/2-12	3.320	84.33	0.720	2 1/2	2.500	63.50	•		•	

## FP-FJS Straight 6506 Series

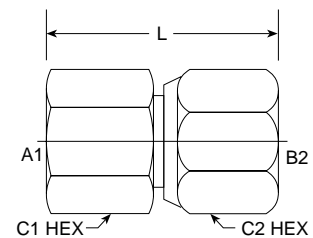

PART NO. SIZE	TUBE O.D.	A1 NPTF	B2 SAE 37	L LGTH	M.M.	C1 HEX	C1 HEX	M.M.	C2 HEX	C2 HEX	M.M.	Standard Material From Stock			
												S	FG	SS	B
6506-02-04	1/4	1/8-27	7/16-20	1.200	30.48	9/16	0.562	14.29	9/16	0.562	14.28	•		•	
6506-04-04	1/4	1/4-18	7/16-20	1.320	33.53	11/16	0.687	17.45	9/16	0.562	14.28	•		•	
6506-04-05	5/16	1/4-18	1/2-20	1.660	42.16	3/4	0.750	19.05	5/8	0.625	15.87	•		•	
6506-04-06	3/8	1/4-18	9/16-18	1.480	37.59	11/16	0.687	17.45	11/16	0.687	20.63	•		•	
NEW 6506-06-04	3/8	3/8-18	9/16-18	1.630	41.40	7/8	0.875	22.23	11/16	0.687	20.63	•		•	
6506-06-06	1/2	3/8-18	3/4-16	1.700	43.18	7/8	0.875	22.23	7/8	0.875	22.22	•		•	
6506-06-08	5/8	3/8-18	7/8-14	2.000	50.80	1	1.000	25.40	1	1.000	25.40	•		•	
6506-08-06	3/8	1/2-14	9/16-18	1.810	45.97	1 1/16	1.062	26.98	11/16	0.687	20.63	•		•	
6506-08-08	1/2	1/2-14	3/4-16	1.810	45.97	1	1.000	25.40	7/8	0.875	22.22	•		•	
6506-08-10	5/8	1/2-14	7/8-14	2.080	52.83	1 1/8	1.125	28.58	1	1.000	25.40	•		•	
6506-08-12	3/4	1/2-14	1 1/16-12	2.170	55.12	1 1/8	1.125	28.58	1 1/4	1.250	31.75	•		•	
6506-12-10	5/8	3/4-14	7/8-14	1.940	49.28	1 1/4	1.250	31.75	1	1.000	25.40	•		•	
6506-12-12	3/4	3/4-14	1 1/16-12	2.080	52.83	1 1/4	1.250	31.75	1 1/4	1.250	31.75	•		•	
6506-12-14	7/8	3/4-14	1 3/16-12	2.120	53.85	1 5/16	1.312	33.32	1 3/8	1.375	34.93	•		•	
6506-12-16	1	3/4-14	1 5/16-12	2.330	59.18	1 3/8	1.375	34.92	1 1/2	1.500	38.10	•		•	
6506-16-16	1	1-11 1/2	1 5/16-12	2.620	66.55	1 1/2	1.500	38.10	1 1/2	1.500	38.10	•		•	
6506-20-20	1 1/4	1 1/4-11 1/2	1 5/8-12	2.740	69.60	2	2.000	50.80	2	2.000	50.80	•		•	
6506-24-24	1 1/2	1 1/2-11 1/2	1 7/8-12	2.820	71.63	2 3/8	2.375	60.33	2 1/4	2.250	57.15	•		•	
6506-32-32	2	2-11 1/2	2 1/2-12	3.150	80.01	2 7/8	2.875	73.03	2 7/8	2.875	73.02	•		•	