

Hollow Hex Pipe Plug 5406-HP Series

SAE # 130109

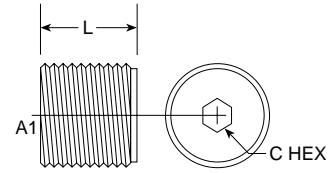

PART NO. SIZE	PIPE O.D.	A1 NPTF	L LGTH	M.M.	C HEX	C HEX	M.M.	Standard Material From Stock			
								S	FG	SS	B
5406-HP-01	1/16	1/16-27	0.300	7.62	5/32	0.156	3.96	•		•	
5406-HP-02	1/8	1/8-27	0.300	7.62	3/16	0.188	4.76	•		•	•
5406-HP-04	1/4	1/4-18	0.460	11.68	1/4	0.250	6.35	•		•	•
5406-HP-06	3/8	3/8-18	0.460	11.68	5/16	0.312	7.92	•		•	•
5406-HP-08	1/2	1/2-14	0.610	15.49	3/8	0.375	9.53	•		•	•
5406-HP-12	3/4	3/4-14	0.620	15.75	9/16	0.562	14.27	•		•	•
5406-HP-16	1	1-11 1/2	0.770	19.56	5/8	0.625	15.88	•		•	
5406-HP-20	1 1/4	1 1/4-11 1/2	0.830	21.08	3/4	0.750	19.05	•		•	
5406-HP-24	1 1/2	1 1/2-11 1/2	0.830	21.08	1	1.000	25.40	•		•	
5406-HP-32	2	2-11 1/2	0.830	21.08	1	1.000	25.40	•		•	

External Hex Pipe Plug 5406-P Series

SAE # 130109E

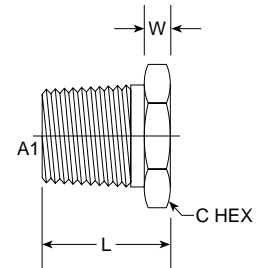

PART NO. SIZE	PIPE O.D.	A1 NPTF	L LGTH	M.M.	W WIDTH	M.M.	C HEX	C HEX	M.M.	Standard Material From Stock			
										S	FG	SS	B
NEW 5405-P-01										•			
5406-P-02	1/8	1/8-27	0.562	14.27	0.187	4.75	7/16	0.438	11.13	•		•	
5406-P-04	1/4	1/4-18	0.750	19.05	0.187	4.75	9/16	0.562	14.27	•		•	
5406-P-06	3/8	3/8-18	0.781	19.84	0.219	5.56	11/16	0.688	17.46	•		•	•
5406-P-08	1/2	1/2-14	1.120	28.45	0.220	5.59	7/8	0.875	22.23	•		•	•
5406-P-12	3/4	3/4-14	1.170	29.72	0.420	10.67	1 1/8	1.125	28.58	•		•	•
5406-P-16	1	1-11 1/2	1.360	34.54	0.420	10.67	1 3/8	1.375	34.93	•		•	
5406-P-20	1 1/4	1 1/4-11 1/2	1.468	37.29	0.500	12.70	1 3/4	1.750	44.45	•		•	
5406-P-24	1 1/2	1 1/2-11 1/2	1.570	39.88	0.570	14.48	2	2.000	50.80	•		•	
5406-P-32	2	2-11 1/2	1.750	44.45	0.718	18.24	2 1/2	2.500	63.50	•		•	

Square Head Pipe Plug 5406-SHP Series

SAE # 130109A

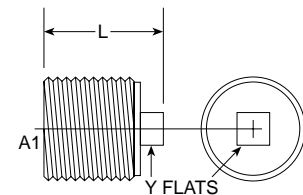

PART NO. SIZE	PIPE O.D.	A1 NPTF	L LGTH	M.M.	Y FLATS	Y FLATS	M.M.	Standard Material From Stock			
								S	FG	SS	B
5406-SHP-02	1/8	1/8-27	0.630	16.00	9/32	0.281	7.11	•		•	
5406-SHP-04	1/4	1/4-18	0.760	19.30	3/8	0.375	9.65	•		•	•
5406-SHP-06	3/8	3/8-18	0.845	21.46	7/16	0.437	10.92	•		•	
5406-SHP-08	1/2	1/2-14	1.000	25.40	9/16	0.558	16.66	•		•	
5406-SHP-12	3/4	3/4-14	1.080	27.43	5/8	0.625	15.75	•		•	
5406-SHP-16	1	1-11 1/2	1.270	32.26	13/16	0.812	20.32	•		•	
5406-SHP-20	1 1/4	1 1/4-11 1/2	1.400	35.56	15/16	0.937	23.62	•		•	
5406-SHP-24	1 1/2	1 1/2-11 1/2	1.470	37.34	1 1/8	1.125	28.58	•		•	