

# FP-FP Straight 5000 Series

SAE # 140138

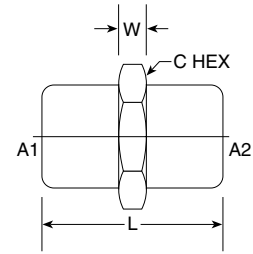

PART NO. SIZE	PIPE O.D.	A1 NPTF	A2 NPTF	L LGTH	M.M.	W WIDTH	M.M.	C HEX	C HEX	M.M.	Standard Material From Stock			
											S	FG	SS	B
5000-02-02	1/8	1/8-27	1/8-27	0.750	19.05	0.220	5.59	5/8	0.625	15.88	•		•	•
5000-04-02	1/4	1/4-18	1/8-27	1.130	28.70	0.250	6.35	3/4	0.750	19.05	•		•	•
5000-04-04	1/4	1/4-18	1/4-18	1.130	28.70	0.250	6.35	3/4	0.750	19.05	•		•	•
5000-06-02	3/8	3/8-18	1/8-27	1.130	28.70	0.250	6.35	7/8	0.875	22.23	•		•	•
5000-06-04	3/8	3/8-18	1/4-18	1.130	28.70	0.250	6.35	7/8	0.875	22.23	•		•	•
5000-06-06	3/8	3/8-18	3/8-18	1.130	28.70	0.250	6.35	7/8	0.875	22.23	•		•	•
5000-08-02	1/2	1/2-14	1/8-27	1.500	38.10	0.310	7.87	1 1/8	1.125	28.58	•		•	•
5000-08-04	1/2	1/2-14	1/4-18	1.500	38.10	0.310	7.87	1 1/8	1.125	28.58	•		•	•
5000-08-06	1/2	1/2-14	3/8-18	1.500	38.10	0.310	7.87	1 1/8	1.125	28.58	•		•	•
5000-08-08	1/2	1/2-14	1/2-14	1.500	38.10	0.310	7.87	1 1/8	1.125	28.58	•		•	•
5000-12-04	3/4	3/4-14	1/4-18	1.530	38.86	0.380	9.65	1 3/8	1.375	34.93	•		•	•
5000-12-06	3/4	3/4-14	3/8-18	1.530	38.86	0.380	9.65	1 3/8	1.375	34.93	•		•	•
5000-12-08	3/4	3/4-14	1/2-14	1.530	38.86	0.380	9.65	1 3/8	1.375	34.93	•		•	•
5000-12-12	3/4	3/4-14	3/4-14	1.530	38.86	0.380	9.65	1 3/8	1.375	34.93	•		•	•
5000-16-06	1	1-11 1/2	3/8-18	1.890	48.01	0.380	9.65	1 5/8	1.625	41.28	•		•	•
5000-16-08	1	1-11 1/2	1/2-14	1.890	48.01	0.380	9.65	1 5/8	1.625	41.28	•		•	•
5000-16-12	1	1-11 1/2	3/4-14	1.890	48.01	0.380	9.65	1 5/8	1.625	41.28	•		•	•
5000-16-16	1	1-11 1/2	1-11 1/2	1.890	48.01	0.380	9.65	1 5/8	1.625	41.28	•		•	•
5000-20-12	1 1/4	1 1/4-11 1/2	3/4-14	1.930	49.02	0.460	11.68	2	2.000	50.80	•		•	•
5000-20-16	1 1/4	1 1/4-11 1/2	1-11 1/2	1.930	49.02	0.460	11.68	2	2.000	50.80	•		•	•
5000-20-20	1 1/4	1 1/4-11 1/2	1 1/4-11 1/2	1.930	49.02	0.460	11.68	2	2.000	50.80	•		•	•
5000-24-16	1 1/2	1 1/2-11 1/2	1-11 1/2	1.930	49.02	0.530	13.46	2 3/8	2.375	60.33	•		•	•
5000-24-20	1 1/2	1 1/2-11 1/2	1 1/4-11 1/2	1.930	49.02	0.530	13.46	2 3/8	2.375	60.33	•		•	•
5000-24-24	1 1/2	1 1/2-11 1/2	1 1/2-11 1/2	1.930	49.02	0.530	13.46	2 3/8	2.375	60.33	•		•	•
5000-32-24	2	2-11 1/2	1 1/2-11 1/2	2.000	50.80	6.600	167.64	2 7/8	2.875	73.03	•		•	•
5000-32-32	2	2-11 1/2	2-11 1/2	1.960	49.78	0.680	17.27	2 7/8	2.875	73.03	•		•	•

# MP-BW Weld-on Fitting 304SS 5304 Series

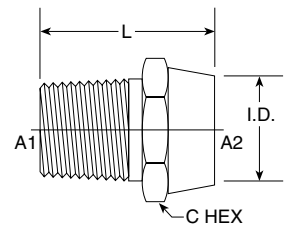

PART NO. SIZE	PIPE O.D.	A1 NPTF	A2 WELD-ON	I.D.	M.M.	L LGTH	M.M.	C HEX	C HEX	M.M.	Standard Material From Stock			
											S	FG	SS	B
5304-04	1/4	1/4-18	1/4	0.250	6.35	1.197	30.40	9/16	0.562	14.28			•	
5304-06	3/8	3/8-18	3/8	0.375	9.52	1.250	31.75	11/16	0.687	17.46			•	
5304-08	1/2	1/2-14	1/2	0.500	12.70	1.438	36.53	7/8	0.875	22.22			•	
5304-12	3/4	3/4-14	3/4	0.750	19.05	1.500	38.10	1 1/16	1.062	26.99			•	
5304-16	1	1-11 1/2	1	1.000	25.40	1.700	43.18	1 5/16	1.312	33.33			•	
5304-20	1 1/4	1 1/4-11 1/2	1 1/4	1.250	31.75	1.940	49.28	1 3/4	1.750	44.45			•	
5304-24	1 1/2	1 1/2-11 1/2	1 1/2	1.500	63.50	2.138	54.31	2	2.000	50.80			•	