

BULN 0306-N Series

SAE # 070117

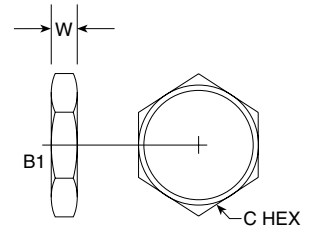

PART NO. SIZE	TUBE O.D.	B1 THREAD	W WIDTH M.M.	C HEX	C HEX	M.M.	Standard Material From Stock				
							S	FG	SS	B	
0306-N-03	3/16	3/8-24	0.223	5.66	1/2	0.500	12.70			•	
0306-N-04	1/4	7/16-20	0.250	6.35	9/16	0.562	14.27	•		•	
0306-N-05	5/16	1/2-20	0.250	6.35	5/8	0.625	15.88	•		•	
0306-N-06	3/8	9/16-18	0.270	6.86	11/16	0.687	17.45	•		•	
0306-N-08	1/2	3/4-16	0.310	7.87	7/8	0.875	22.23	•		•	
0306-N-10	5/8	7/8-14	0.360	9.14	1	1.000	25.40	•		•	
0306-N-12	3/4	1 1/16-12	0.410	10.41	1 1/4	1.250	31.75	•		•	
0306-N-14	7/8	1 3/16-12	0.406	10.31	1 3/8	1.375	34.93	•		•	
0306-N-16	1	1 5/16-12	0.406	10.31	1 1/2	1.500	38.10	•		•	

JIC Tube Nut 0318 Series

SAE # 070110

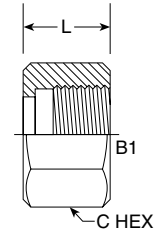

PART NO. SIZE	TUBE O.D.	B1 THREAD	L LGTH M.M.	C HEX	C HEX	M.M.	Standard Material From Stock				
							S	FG	SS	B	
0318-02	1/8	5/16-24	0.540	13.72	3/8	0.375	9.53	•		•	•
0318-03	3/16	3/8-24	0.600	15.24	7/16	0.438	11.13	•		•	•
0318-04	1/4	7/16-20	0.610	15.49	9/16	0.562	14.27	•		•	•
0318-05	5/16	1/2-20	0.670	17.02	5/8	0.625	15.88	•		•	•
0318-06	3/8	9/16-18	0.720	18.29	11/16	0.688	17.48	•		•	•
0318-08	1/2	3/4-16	0.840	21.34	7/8	0.875	22.23	•		•	•
0318-10	5/8	7/8-14	0.970	24.64	1	1.000	25.40	•		•	•
0318-12	3/4	1 1/16-12	1.020	25.91	1 1/4	1.250	31.75	•		•	•
0318-14	7/8	1 3/16-12	1.080	27.43	1 3/8	1.375	34.93	•		•	•
0318-16	1	1 5/16-12	1.120	28.45	1 1/2	1.500	38.10	•		•	•
0318-20	1 1/4	1 5/8-12	1.220	30.99	2	2.000	50.80	•		•	•
0318-24	1 1/2	1 7/8-12	1.410	35.81	2 1/4	2.250	57.15	•		•	•
0318-32	2	2 1/2-12	1.740	44.20	2 7/8	2.875	73.03	•		•	•
0318-40	2 1/2	3-12	1.638	41.61	3 3/8	3.375	85.73	•		•	•

PART NO. SIZE	TUBE O.D.	L LGTH M.M.	M.M.	Standard Material From Stock			
				S	FG	SS	B
V0319-02	1/8	0.340	8.64	•		•	•
V0319-03	3/16	0.340	8.64	•		•	•
V0319-04	1/4	0.410	10.41	•		•	•
V0319-05	5/16	0.440	11.18	•		•	•
V0319-06	3/8	0.500	12.70	•		•	•
V0319-08	1/2	0.560	14.22	•		•	•
V0319-10	5/8	0.660	16.76	•		•	•
V0319-12	3/4	0.680	17.27	•		•	•
V0319-14	7/8	0.760	19.30	•		•	•
V0319-16	1	0.780	19.81	•		•	•
V0319-20	1 1/4	0.910	23.11	•		•	•
V0319-24	1 1/2	1.120	28.45	•		•	•
V0319-32	2	1.190	30.23	•		•	•

JIC Tube Sleeve 0319 Series

SAE # 070115

