

# Tube Fittings & Adapters

## JIC Cap Nut 0304-C Series

SAE# 070112

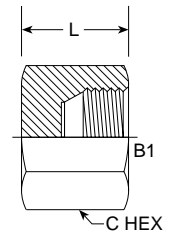

PART NO. SIZE	TUBE O.D.	B1 THREAD	L LGTH	M.M.	C HEX	C HEX	M.M.	Standard Material From Stock			
								S	FG	SS	B
0304-C-02	1/8	5/16-24	0.500	12.70	3/8	0.375	9.53	•		•	•
0304-C-03	3/16	3/8-24	0.562	14.27	7/16	0.438	11.13	•		•	•
0304-C-04	1/4	7/16-20	0.594	15.09	9/16	0.562	14.27	•		•	•
0304-C-05	5/16	1/2-20	0.609	15.47	5/8	0.625	15.88	•		•	•
0304-C-06	3/8	9/16-18	0.625	15.88	11/16	0.687	17.45	•		•	•
0304-C-08	1/2	3/4-16	0.750	19.05	7/8	0.875	22.23	•		•	•
0304-C-10	5/8	7/8-14	0.844	21.44	1	1.000	25.40	•		•	•
0304-C-12	3/4	1 1/16-12	0.906	23.01	1 1/4	1.250	31.75	•		•	•
0304-C-14	7/8	1 3/16-12	0.969	24.61	1 3/8	1.375	34.93	•		•	•
0304-C-16	1	1 5/16-12	1.016	25.81	1 1/2	1.500	38.10	•		•	•
0304-C-20	1 1/4	1 5/8-12	1.062	26.97	2	2.000	50.80	•		•	•
0304-C-24	1 1/2	1 7/8-12	1.188	30.18	2 1/4	2.250	57.15	•		•	•
0304-C-32	2	2 1/2-12	1.438	36.53	2 7/8	2.875	73.03	•		•	•

## BHLN 0306 Series

SAE# 070118 / MS# 51860

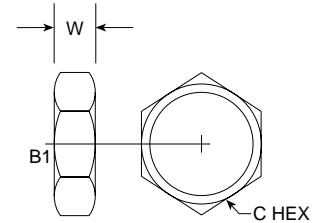

PART NO. SIZE	TUBE O.D.	B1 THREAD	W WIDTH	M.M.	C HEX	C HEX	M.M.	Standard Material From Stock			
								S	FG	SS	B
0306-02	1/8	5/16-24	0.220	5.60	9/16	0.562	14.28	•		•	
0306-03	3/16	3/8-24	0.220	5.60	5/8	0.625	15.87	•		•	
0306-04	1/4	7/16-20	0.250	6.35	11/16	0.687	17.46	•		•	
0306-05	5/16	1/2-20	0.250	6.35	3/4	0.750	19.05	•		•	
0306-06	3/8	9/16-18	0.281	7.14	13/16	0.812	20.64	•		•	
0306-08	1/2	3/4-16	0.343	8.71	1	1.000	25.40	•		•	
0306-10	5/8	7/8-14	0.391	9.93	1 1/8	1.125	28.58	•		•	
0306-12	3/4	1 1/16-12	0.438	11.13	1 3/8	1.375	34.93	•		•	
0306-14	7/8	1 3/16-12	0.406	10.31	1 1/2	1.500	38.10	•		•	
0306-16	1	1 5/16-12	0.406	10.31	1 5/8	1.625	41.28	•		•	
0306-20	1 1/4	1 5/8-12	0.406	10.31	1 7/8	1.875	47.63	•		•	
0306-24	1 1/2	1 7/8-12	0.421	10.46	2 1/8	2.125	53.98	•		•	
0306-32	2	2 1/2-12	0.406	10.31	2 3/4	2.750	69.85	•		•	